



meccanocar

User manual

4770007480

Adattabile per Gruppo VW 1.2 - 1.6 - 2.0
TDi CR

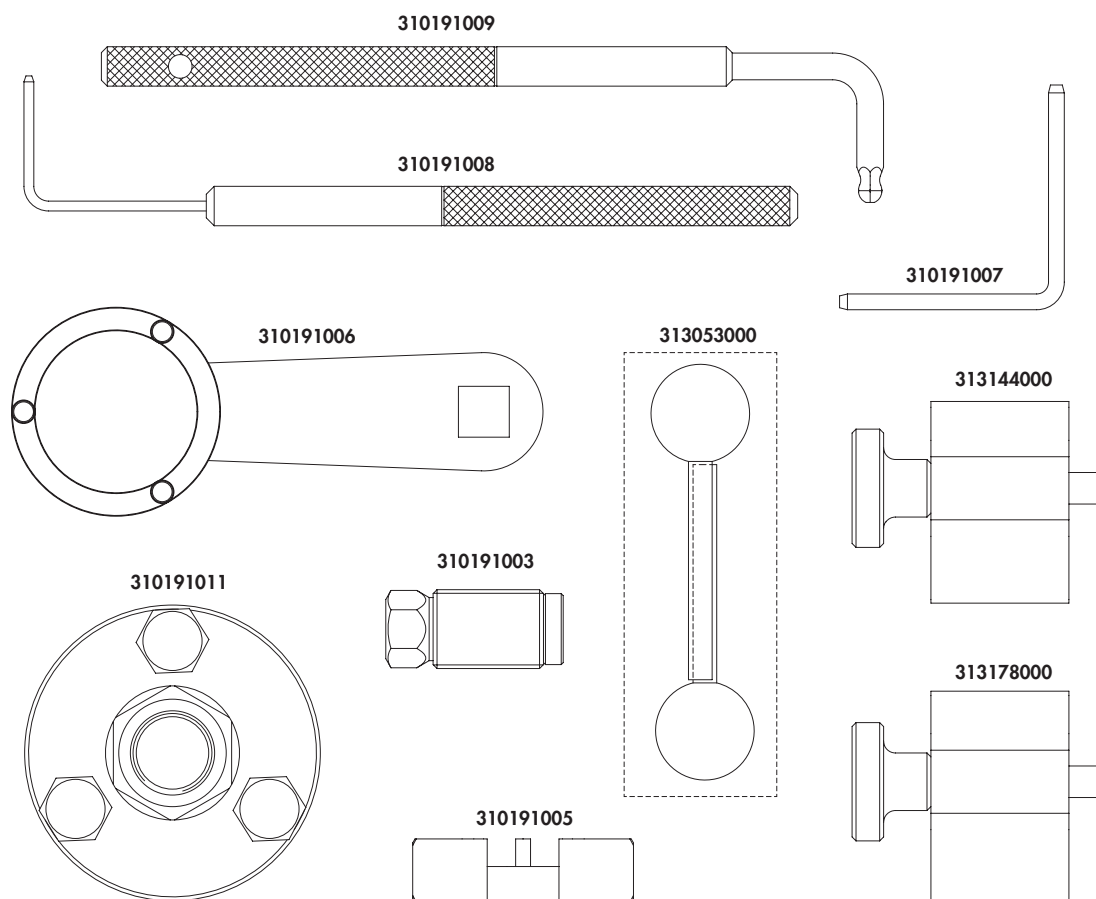

Adaptable pour Groupe VW 1.2 - 1.6 - 2.0 TDi CR **FR**

Suitable for VW Group 1.2 - 1.6 - 2.0 TDi CR **EN**



Componenti

310191009	T10264	ATTREZZO DI REGISTRAZIONE DELLA PULEGGIA DEL TENDICINGHIA	
310191008	T10265	ATTREZZO DI BLOCCAGGIO DELLA PULEGGIA DEL TENDICINGHIA	
310191006	T10051	ATTREZZO DI BLOCCAGGIO DELLA PULEGGIA ALBERO A CAMME	
310191011	T10052	ESTRATTORE CORPO PULEGGIA ALBERO A CAMME	
313053000	3359	PERNO BLOCCAGGIO PIGNONE ALBERO CAMME / POMPA INIEZIONE	 x2
310191007	T40098 / T10060(A)	TENDICINGHIA (ORGANI AUSILIARI)	
313144000	T10050	ATTREZZO DI BLOCCAGGIO DEL PIGNONE ALBERO MOTORE (ROTONDO)	

313178000	T10100	ATTREZZO DI BLOCCAGGIO DEL PIGNONE OVALE ALBERO MOTORE	
310191005	T10255	ALLINEAMENTO ALBERO POMPA DELL'OLIO	

PRECAUZIONI SPECIALI - LEGGERE ATTENTAMENTE

- **Utilizzare guanti antinfortunistici, scarpe antinfortunistiche, elmetto e occhiali di protezione**

- **Uso improprio:**

Il prodotto deve essere destinato solo ed esclusivamente all'uso descritto in questa documentazione, ogni altro uso è da considerarsi improprio.

Il produttore declina ogni responsabilità per possibili danni causati da usi errati o irragionevoli dell'attrezzatura;

L'uso improprio invalida inoltre la garanzia.

- **Tenere gli attrezzi con cura:**

Conservare sempre gli attrezzi puliti.

Riporre gli attrezzi all'interno della confezione originale.

- Scollegare il cavo della batteria dal polo negativo di terra (verificare il codice radio se disponibile)
- Rimuovere le candele o le candele per facilitare la rotazione del motore
- Non utilizzare detersivi liquidi su cinghie, pignoni o tensionatori
- Segnare il senso di rotazione della cinghia ausiliaria prima di rimuoverla
- Ruotare il motore in senso orario (antiorario solo se specificato)

- Non ruotare mai l'albero a camme, l'albero motore o la pompa d'iniezione diesel quando la catena è già stata rimossa (a meno che non sia specificato)
- Non utilizzare la catena di distribuzione per bloccare il motore quando si allentano o si stringono i bulloni della puleggia dell'albero motore
- Non ruotare l'albero motore o l'albero a camme quando la cinghia/catena è già stata rimossa
- Prima di rimuovere la catena, segnare la sua direzione
- È sempre consigliato ruotare il motore lentamente manualmente e riverificare il posizionamento dell'albero motore e dell'albero a camme
- Gli alberi a camme e motore possono essere ruotati solamente quando il meccanismo di azionamento della catena/cinghia è completamente installato.
- Non ruotare il motore azionando l'albero a camme o altri ingranaggi
- Verificare la corretta posizione della pompa d'iniezione diesel dopo aver sostituito la catena
- Osservare tutte le coppie di serraggio
- Attenersi sempre al manuale della casa costruttrice o al libretto d'istruzioni fornito
- Una fasatura del motore non precisa o sbagliata comporta il danneggiamento delle valvole

APPLICAZIONE

SKODA	Roomster, Fabia, Praktik, Octavia, Yeti, Superb	
AUDI	A1, A3, A4, A5, Q5, A6, TT	1.2 TDI CR, 1.6 D TDI CR, 2.0 D TDI CR
VW	Jetta, Touran, Golf, Golf Plus, Polo, Passat, Tiguan, Scirocco	
SEAT	Exeo, Leon, Altea, Toledo, Ibiza	





CAGA, CAGB, CAGC, CAHA, CAHB, CFHC, CBAA, CBAB, CFFB, CFG, CGLA, CGLB, CJCA, CJCB, CAAA, CBAA, CBAB, CBAC, CBBA, CBBB, CBDA, CBDB, CBDC, CCHA, CEGA, CJAA, CAAB, CAAC, CFJA, CFWA, CAYB, CAYC, CAYA

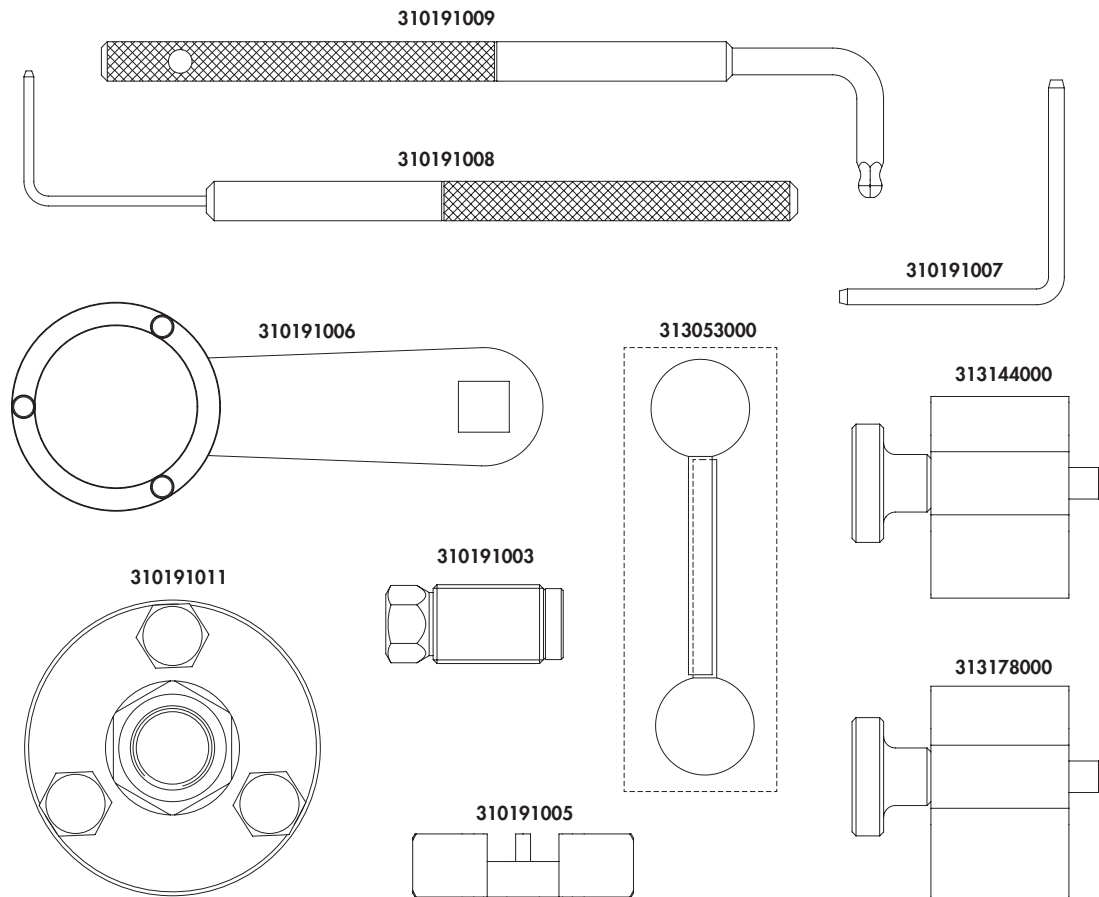

VW GROUP	Codice OEM				
	3359	T10050	T10100	T10264	T10265
Codice motore					
CAGA, CAGB, CAGC, CAHA, CAHB, CFHC, CBAA, CBAB, CFFB, CFG, CGLA, CGLB, CJCA, CJCB, CAAA, CBAA, CBAB, CBAC, CBBA, CBBB, CBDA, CBDB, CBDC, CCHA, CEGA, CJAA, CAAB, CAAC, CFJA, CFWA	•	•	•	•	•
CAYA, CAYB, CAYC	•	•	•	•	•

VW GROUP	Codice OEM			
	T10051	T10052	T10255	T40098 / T10060(A)
Codice motore				
CAGA, CAGB, CAGC, CAHA, CAHB, CFHC, CBAA, CBAB, CFFB, CFG, CGLA, CGLB, CJCA, CJCB, CAAA, CBAA, CBAB, CBAC, CBBA, CBBB, CBDA, CBDB, CBDC, CCHA, CEGA, CJAA, CAAB, CAAC, CFJA, CFWA	•	•	•	•
CAYA, CAYB, CAYC	•	•	•	•

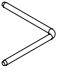

Composants

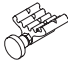
310191009	T10264	OUTIL MISE EN FASE DE LA POUILE DU TENDEUR	
310191008	T10265	OUTIL POUR BLOQUER LA POUILE DU TENDEUR	
310191006	T10051	OUTIL DE SERRAGE POULIE ARBRE À CAMES	
310191011	T10052	EXTRACTEUR DU CORP DE LA POUILE ARBRE À CAME	
313053000	3359	PIGE DE BLOCAGE ARBRE À CAMES / POMPE D'INJECTION	 x2
310191007	T40098 / T10060(A)	TENDEUR DE LA COURROIE D'ACCESSOIRES	
313144000	T10050	OUTIL DE BLOCAGE PIGNON D'ARBRE MOTEUR (ROND)	

313178000	T10100	OUTIL DE BLOCAGE DU PIGNON OVAL D'ARBRE MOTEUR	
310191005	T10255	ALIGNEMENT ARBRE POMPE DE L'HUILE	

PRÉCAUTIONS SPÉCIALES - LIRE ATTENTIVEMENT

- **Utiliser des gants anti-accident, des chaussures anti-accident, un casque de protection et des lunettes de protection**

- **Usage impropre:**

Le produit ne doit être utilisé que pour l'usage prévu dans la présente documentation. Tout autre usage doit être considéré comme impropre.

Le producteur décline toute responsabilité pour tout dommage découlant d'usages erronés ou irraisonnables de l'équipement.

L'usage impropre annule la garantie.

- **Prendre bien soin des outils:**

Toujours garder les outils bien propres.

Ranger les outils dans leur emballage d'origine.

- Débrancher le câble de la batterie du pôle négatif de terre (vérifier le code radio si disponible)
- Enlever les bougies afin de faciliter la rotation du moteur
- Ne pas utiliser de détergents liquides sur les courroies, les pignons et les tensionneurs
- Indiquer le sens de rotation de la courroie auxiliaire avant de l'enlever
- Faire tourner le moteur dans le sens des aiguilles d'une

montre (contraire seulement si spécifié)

- Ne jamais faire tourner l'arbre à cames, l'arbre moteur ou la pompe d'injection diesel lorsque la chaîne a déjà été enlevé (à moins que ce soit spécifié)
- Ne pas utiliser la chaîne de distribution pour bloquer le moteur quand les boulons de la poulie de l'arbre moteur se serrent ou se desserrent
- Ne pas faire tourner l'arbre moteur ou l'arbre à came lorsque la courroie/chaîne a déjà été enlevée
- Avant d'enlever la chaîne, indiquer sa direction
- Il est toujours conseillé de faire tourner lentement le moteur de façon manuelle et de revérifier le positionnement de l'arbre moteur et de l'arbre à cames.
- Les arbres à cames et moteur peuvent être tournée seulement lorsque le mécanisme d'actionnement de la chaîne/courroie est complètement installé.
- Ne pas faire tourner le moteur en actionnant l'arbre à cames ou d'autres engrenages
- Vérifier la position correcte de la pompe d'injection diesel après avoir remplacé la chaîne
- Observer tous les couples de serrage
- Toujours se reporter au manuel de maison constructrice ou au mode d'emploi fourni
- Une synchronisation du moteur imprécise ou raté entraîne l'endommagement des vannes

APPLICATION

SKODA	Roomster, Fabia, Praktik, Octavia, Yeti, Superb	
AUDI	A1, A3, A4, A5, Q5, A6, TT	1.2 TDI CR, 1.6 D TDI CR, 2.0 D TDI CR
VW	Jetta, Touran, Golf, Golf Plus, Polo, Passat, Tiguan, Scirocco	
SEAT	Exeo, Leon, Altea, Toledo, Ibiza	





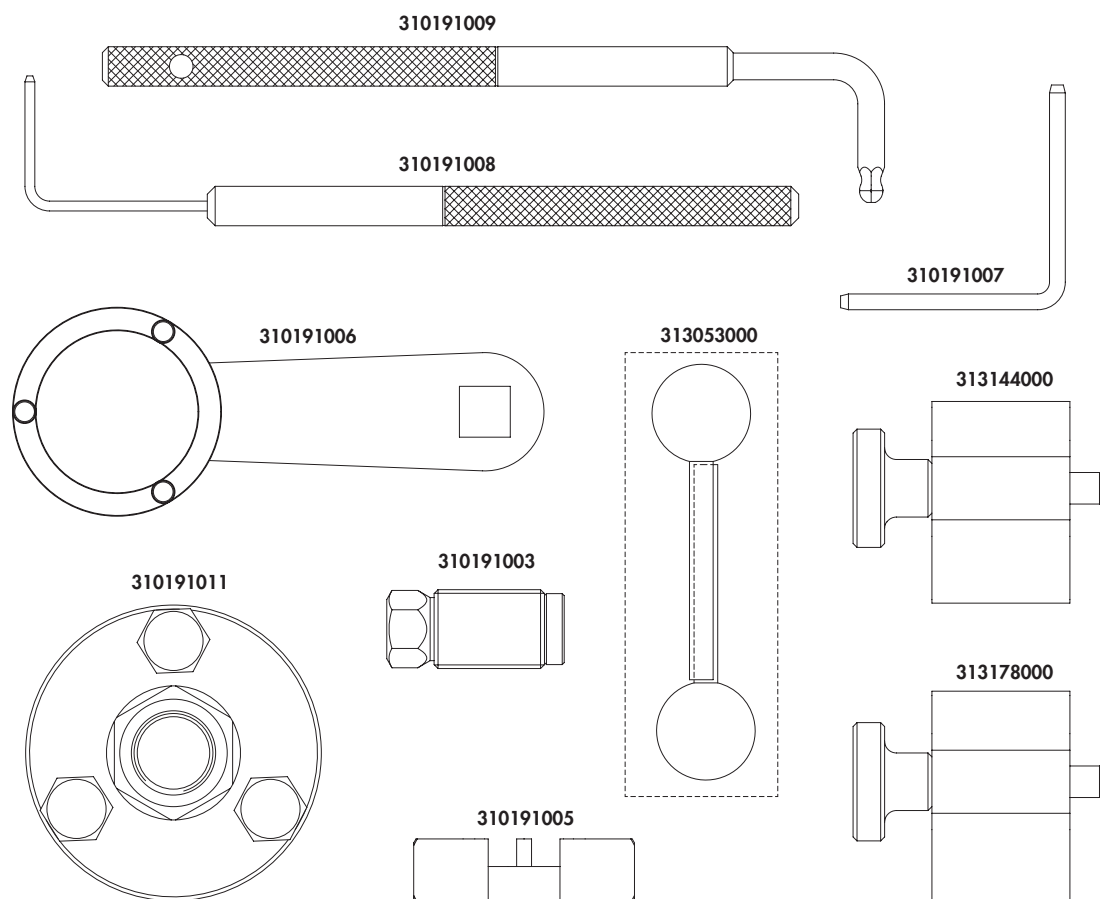

CAGA, CAGB, CAGC, CAHA, CAHB, CFHC, CBAA, CBAB, CFFB, CFG, CGLA, CGLB, CJCA, CJCB, CAAA, CBAA, CBAB, CBAC, CBBA, CBBB, CBDA, CBDB, CBDC, CCHA, CEGA, CJAA, CAAB, CAAC, CFJA, CFWA, CAYB, CAYC, CAYA



VW GROUP	Code OEM				
	3359	T10050	T10100	T10264	T10265
Code moteur					
CAGA, CAGB, CAGC, CAHA, CAHB, CFHC, CBAA, CBAB, CFFB, CFG, CGLA, CGLB, CJCA, CJCB, CAAA, CBAA, CBAB, CBAC, CBBA, CBBB, CBDA, CBDB, CBDC, CCHA, CEGA, CJAA, CAAB, CAAC, CFJA, CFWA	•	•	•	•	•
CAYA, CAYB, CAYC	•	•	•	•	•

VW GROUP	Code OEM			
	T10051	T10052	T10255	T40098 / T10060(A)
Code moteur				
CAGA, CAGB, CAGC, CAHA, CAHB, CFHC, CBAA, CBAB, CFFB, CFG, CGLA, CGLB, CJCA, CJCB, CAAA, CBAA, CBAB, CBAC, CBBA, CBBB, CBDA, CBDB, CBDC, CCHA, CEGA, CJAA, CAAB, CAAC, CFJA, CFWA	•	•	•	•
CAYA, CAYB, CAYC	•	•	•	•



Components

310191009	T10264	TENSIONER PULLEY TOOL	
310191008	T10265	TENSIONER PULLEY LOCKING TOOL	
310191006	T10051	LOCKING TOOL FOR CAMSHAFT PULLEY	
310191011	T10052	CAMSHAFT REMOVER TOOL	
313053000	3359	CAMSHAFT/INJECTION PUMP PIN	 x2
310191007	T40098 / T10060(A)	AUXILIARY TENSIONER TOOL	
313144000	T10050	CRANKSHAFT TOOL (ROUND)	

313178000	T10100	CRANKSHAFT TOOL (OVAL)	
310191005	T10255	OIL PUMP SHAFT ALIGNING TOOL	

SAFETY PRECAUTIONS - PLEASE READ

- **Use protective work gloves, protective footwear, hard hat and safety goggles**

- **Misuse:**

This product should only be used as described in this documentation; any other use is considered improper. The manufacturer accepts no responsibility for any damage caused by the incorrect or unreasonable use of the equipment;

Moreover, misuse shall also void the warranty.

- **Take care of your tools:**

Be sure to store your tools in a clean state.

Place the tools inside their original package.

- Disconnect the battery earth leads (check radio code is available)
- Remove spark or glow plugs to make the engine turn easier
- Do not use cleaning fluids on belts, sprockets or rollers
- Always make a note of the route of the auxiliary drive belt before removal
- Turn the engine in the normal direction (clockwise unless stated otherwise)

- Do not turn the camshaft, crankshaft or diesel injection pump once the timing chain has been removed (unless specifically stated)
- Do not use the timing chain to lock the engine when slackening or tightening crankshaft pulley bolts
- Do not turn the crankshaft or camshaft when the timing belt/chain has been removed
- Mark the direction of the chain before removing
- It is always recommended to turn the engine slowly, by hand and to re-check the camshaft and crankshaft timing positions
- Crankshafts and Camshafts may only be turned with the chain drive mechanism fully installed
- Do not turn crankshaft via camshaft or other gears
- Check the diesel injection pump timing after replacing the chain
- Observe all tightening torques
- Always refer to the vehicle manufacturer's service manual or a suitable proprietary instruction book
- Incorrect or out of phase engine timing can result in damage to the valves
- It is always recommended to turn the engine slowly, by hand, and to re-check the camshaft and crankshaft timing positions

APPLICATION

SKODA	Roomster, Fabia, Praktik, Octavia, Yeti, Superb	
AUDI	A1, A3, A4, A5, Q5, A6, TT	1.2 TDI CR, 1.6 D TDI CR, 2.0 D TDI CR
VW	Jetta, Touran, Golf, Golf Plus, Polo, Passat, Tiguan, Scirocco	
SEAT	Exeo, Leon, Altea, Toledo, Ibiza	

CAGA, CAGB, CAGC, CAHA, CAHB, CFHC, CBAA, CBAB, CFFB, CFG, CGLA, CGLB, CJCA, CJCB, CAAA, CBAA, CBAB, CBAC, CBBA, CBBB, CBDA, CBDB, CBDC, CCHA, CEGA, CJAA, CAAB, CAAC, CFJA, CFWA, CAYB, CAYC, CAYA

VW GROUP Engine code	OEM code				
	3359	T10050	T10100	T10264	T10265
CAGA, CAGB, CAGC, CAHA, CAHB, CFHC, CBAA, CBAB, CFFB, CFG, CGLA, CGLB, CJCA, CJCB, CAAA, CBAA, CBAB, CBAC, CBBA, CBBB, CBDA, CBDB, CBDC, CCHA, CEGA, CJAA, CAAB, CAAC, CFJA, CFWA	•	•	•	•	•
CAYA, CAYB, CAYC	•	•	•	•	•

VW GROUP Engine code	OEM code			
	T10051	T10052	T10255	T40098 / T10060(A)
CAGA, CAGB, CAGC, CAHA, CAHB, CFHC, CBAA, CBAB, CFFB, CFG, CGLA, CGLB, CJCA, CJCB, CAAA, CBAA, CBAB, CBAC, CBBA, CBBB, CBDA, CBDB, CBDC, CCHA, CEGA, CJAA, CAAB, CAAC, CFJA, CFWA	•	•	•	•
CAYA, CAYB, CAYC	•	•	•	•



MECCANOCAR ITALIA S.r.l.

Via Malta 2/1 - 16121 Genova - ITALY
Tel. + 39 0587 609433 | Fax + 39 0587 607145
mec@meccanocar.it | www.meccanocar.it