



meccanocar

User manual

4770007510

Adattabile per Gruppo VW 1.8-2.0 TFSI

Adaptable pour Groupe VW 1.8-2.0 TFSI **FR**

Suitable for VW GROUP 1.8-2.0 TFSI **EN**

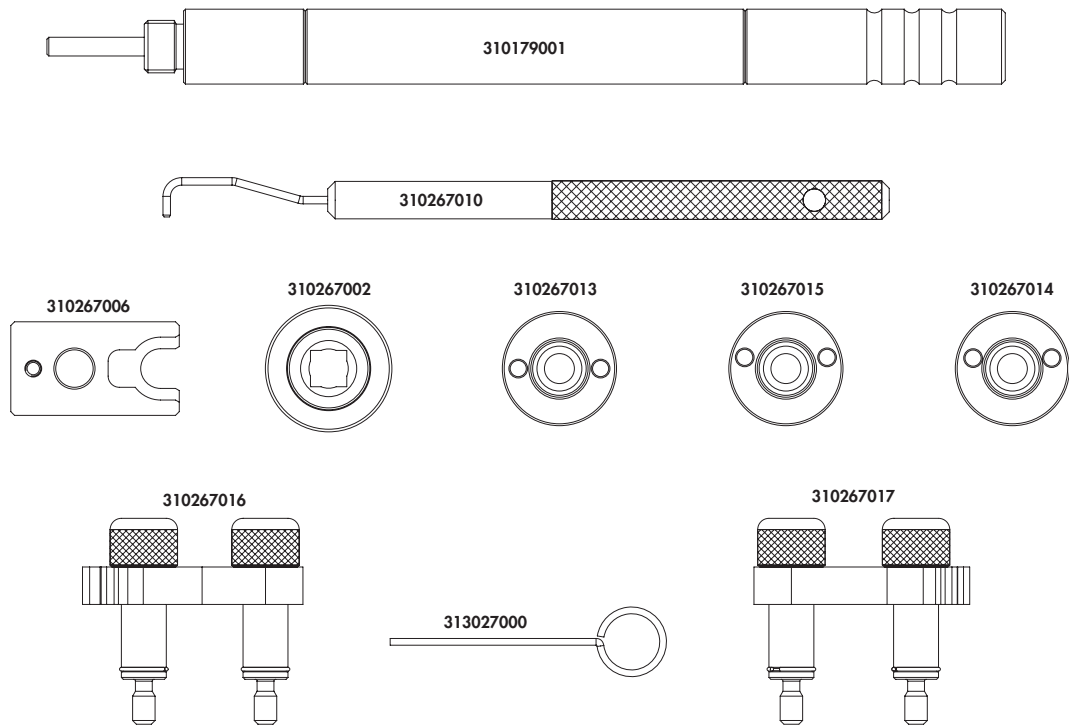

Componenti

313027000	T40011	ATTREZZO DI BLOCCAGGIO TENDICINGHIA	
310179001	T10170; 1.860.895.000	SUPPORTO COMPARATORE	
310267010	T40265	PERNO DI BLOCCAGGIO PULEGGIA TENDICINGHIA	
310267006	T40267	TENDICATENA DI MESSA IN FASE	
310267002	T10352	ADATTATORE PER ATTREZZO DI REGISTRAZIONE ALBERO A CAMME	
310267017	T40271-1	MORSA ALBERO A CAMME (INGRESSO)	

Componenti

310267016	T40271-2	MORSA ALBERO A CAMME (SCARICO)	
310267013	T10352	ATTREZZO DI REGISTRAZIONE ALBERO A CAMME N. 1	
310267015	T10352 T10352/1	ATTREZZO DI REGISTRAZIONE ALBERO A CAMME N. 2	
310267014	T10352 T10352/2	ATTREZZO DI REGISTRAZIONE ALBERO A CAMME N. 3	

PRECAUZIONI SPECIALI - LEGGERE ATTENTAMENTE

- **Utilizzare guanti antinfortunistici, scarpe antinfortunistiche, elmetto e occhiali di protezione**

- **Uso improprio:**

Il prodotto deve essere destinato solo ed esclusivamente all'uso descritto in questa documentazione, ogni altro uso è da considerarsi improprio.

Il produttore declina ogni responsabilità per possibili danni causati da usi errati o irragionevoli dell'attrezzatura;

L'uso improprio invalida inoltre la garanzia.

- **Tenere gli attrezzi con cura:**

Conservare sempre gli attrezzi puliti.

Riporre gli attrezzi all'interno della confezione originale.

- Scollegare il cavo della batteria dal polo negativo di terra (verificare il codice radio se disponibile)
- Rimuovere le candele o le candele per facilitare la rotazione del motore
- Non utilizzare detersivi liquidi su cinghie, pignoni o tensionatori
- Segnare il senso di rotazione della cinghia ausiliaria prima di rimuoverla
- Ruotare il motore in senso orario (antiorario solo se specificato)

- Non ruotare mai l'albero a camme, l'albero motore o la pompa d'iniezione diesel quando la catena è già stata rimossa (a meno che non sia specificato)
- Non utilizzare la catena di distribuzione per bloccare il motore quando si allentano o si stringono i bulloni della puleggia dell'albero motore
- Non ruotare l'albero motore o l'albero a camme quando la cinghia/catena è già stata rimossa
- Prima di rimuovere la catena, segnare la sua direzione
- È sempre consigliato ruotare il motore lentamente manualmente e riverificare il posizionamento dell'albero motore e dell'albero a camme
- Gli alberi a camme e motore possono essere ruotati solamente quando il meccanismo di azionamento della catena/cinghia è completamente installato.
- Non ruotare il motore azionando l'albero a camme o altri ingranaggi
- Verificare la corretta posizione della pompa d'iniezione diesel dopo aver sostituito la catena
- Osservare tutte le coppie di serraggio
- Attenersi sempre al manuale della casa costruttrice o al libretto d'istruzioni fornito
- Una fasatura del motore non precisa o sbagliata comporta il danneggiamento delle valvole

APPLICAZIONI

AUDI	A3 Cabrio	2.0 TFSI	CCZA	2009 - 2013
	A3/A3 Sportback	2.0 TFSI	CCZA	2008 - 2013
	A4	2.0 TFSI	CDNB	2008 - 2012
	A4	2.0 TFSI	CDNB	2008 - 2013
	A4	2.0 TFSI	CDNC	2008 - 2013
	A4	2.0 TFSI FlexFuel	CFKA	2009 - 2015
	A4 allroad	2.0 TFSI	CDNC	2009 - 2013
	A4 quattro	2.0 TFSI	CDNC	2008 - 2013
	A4 quattro	2.0 TFSI FlexFuel	CFKA	2009 - 2015
	A5 Cabriolet	2.0 TFSI	CDNB	2008 - 2012
	A5 Cabriolet	2.0 TFSI	CDNB	2008 - 2013
	A5 Cabriolet	2.0 TFSI	CDNC	2008 - 2013
	A5 Cabriolet	2.0 TFSI	CDNC	2008 - 2014
	A5 Coupe	2.0 TFSI	CDNB	2008 - 2013
	A5 Coupe	2.0 TFSI	CDNB	2008 - 2014
	A5 Coupe	2.0 TFSI	CDNC	2008 - 2013
	A5 Coupe	2.0 TFSI	CDNC	2008 - 2014
	A5 Sportback	2.0 TFSI	CDNB	2009 - 2013
	A5 Sportback	2.0 TFSI	CDNB	2009 - 2014
	A5 Sportback	2.0 TFSI	CDNC	2009 - 2013
	A5 Sportback	2.0 TFSI	CDNC	2009 - 2014
	A6	2.0 TFSI	CDNB	2012 - 2014
	A6	2.0 TFSI	CDNB	2012 - 2015
	Q3	2.0 TFSI	CCZC	2011 - 2015
	Q3	2.0 TFSI	CCZC	2012 - 2015
	Q3	2.0 TFSI	CPSA	2011 - 2015
	Q3	2.0 TFSI	CPSA	2012 - 2015
	Q5	2.0 TFSI	CDNB	2009 - 2012
	Q5	2.0 TFSI	CDNC	2008 - 2012
	Q5	2.0 TFSI	CDNC	2008 - 2013
	TT	2.0 TFSI	CCZA	2008 - 2010
	TT	2.0 TFSI	CESA	2010 - 2014
TT	2.0 TFSI	CETA	2010 - 2014	

APPLICAZIONI

SEAT	Alhambra	2.0 TSI	CCZA	2010 - 2015
	ALTEA/ALTEA XL	2.0 TSI Freetrack	CCZB	2009 - 2015
	LEON	2.0 TFSI FR (Cupra)	CCZB	2009 - 2013
	TOLEDO	2.0 TFSI	CCZB	2009 - 2009
	OCTAVIA II	2.0 vRS	CCZA	2008 - 2013
	SUPERB II	2.0 TSI	CCZA	2009 - 2015

APPLICAZIONI

CC	2.0 TSI	CCZB	2012 - 2015
Eos	2.0 TSI	CCZA	2009 - 2013
Eos	2.0 TSI	CCZB	2009 - 2014
Eos	2.0 TSI	CCZA	2009 - 2014
Eos	2.0 TSI	CCZB	2009 - 2015
Golf Vi	2.0 GTI TSI	CCZB	2009 - 2013
Golf Vi Cabrio	2.0 GTI	CCZB	2012 - 2015
Golf Vi Estate	2.0 TSI	CCZA	2009 - 2013
Jetta	2.0 TSI	CCZA	2011 - 2014
Jetta	2.0 TSI	CCZA	2011 - 2015
Passat	2.0 TSI	CCZB	2011 - 2015
Passat	2.0 TSI	CCZA	2009 - 2011
Passat Alltrack	2.0 TSI	CCZB	2012 - 2015
Passat Cc	2.0 TSI	CCZA	2009 - 2012
Passat Cc	2.0 TSI	CCZB	2010 - 2012
Scirocco	2.0 TSI	CCZB	2009 - 2014
Sharan	2.0 TSI	CCZA	2011 - 2015
Tiguan	2.0 TSI	CCZA	2009 - 2011
Tiguan	2.0 TSI	CCZB	2011 - 2015
Tiguan	2.0 TSI	CCZB	2011 - 2016
Tiguan	2.0 TSI	CCZC	2009 - 2011
Tiguan	2.0 TSI	CCZD	2011 - 2015
Tiguan	2.0 TSI	CCZD	2011 - 2016





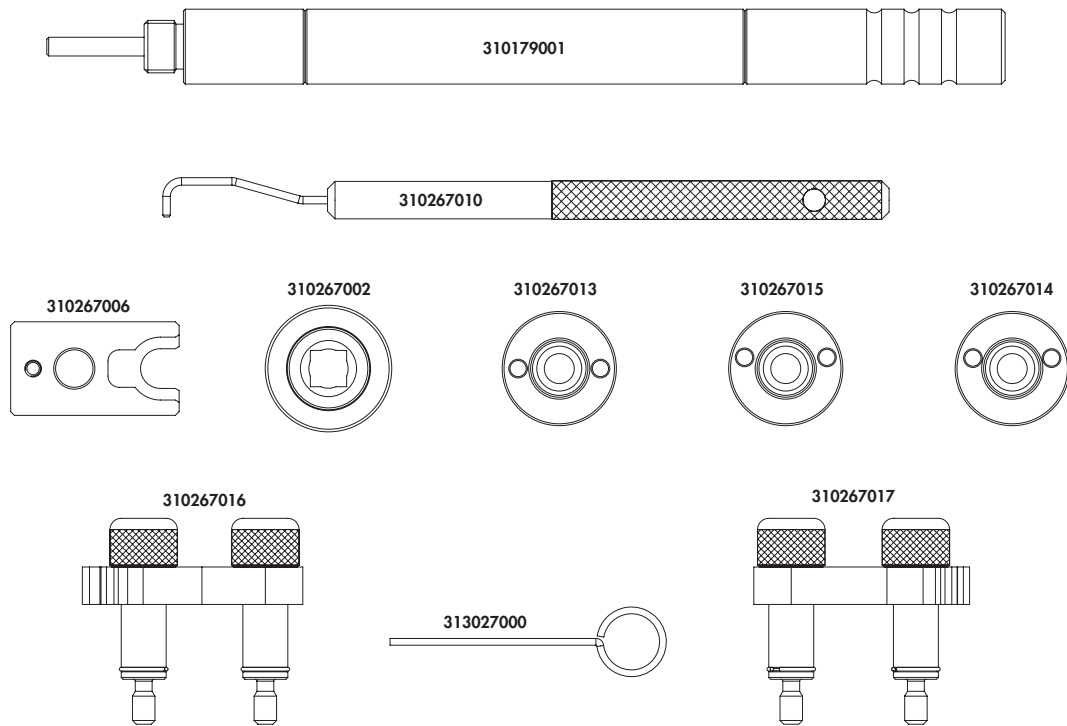

VW

Codice motore	Codice OEM				
	T40011	T10170; 1.860.895.000	T40265	T40267	T10352
CCZA
CDNB
CDNC
CFKA
CCZC
CPSA
CESA
CETA
CCZA
CCZB
CCZB
CCZB
CCZA
CCZB
CCZB
CCZB
CCZC
CCZD





Codice motore	Codice OEM				
	T40271-1	T40271-2	T10352	T10352 T10352/1	T10352 T10352/2
CCZA
CDNB
CDNC
CFKA
CCZC
CPSA
CESA
CETA
CCZA
CCZB
CCZB
CCZB
CCZA
CCZB
CCZB
CCZB
CCZC
CCZD



Composants

313027000	T40011	HERRAMIENTA DE BLOQUEO TENSOR DE CORREA	
310179001	T10170; 1.860.895.000	SOPORTE COMPARADOR	
310267010	T40265	PERNO DE BLOQUEO POLEA TENSOR DE CORREA	
310267006	T40267	TENSOR DE CADENA DE SINCRONIZACIÓN	
310267002	T10352	ADAPTADOR PARA HERRAMIENTA DE REGULACIÓN ÁRBOL DE LEVAS	
310267017	T40271-1	MORDAZA ÁRBOL DE LEVAS (ADMISIÓN)	

Composants

310267016	T40271-2	MORDAZA ÁRBOL DE LEVAS (ESCAPE)	
310267013	T10352	HERRAMIENTA DE REGULACIÓN ÁRBOL DE LEVAS N. 1	
310267015	T10352 T10352/1	HERRAMIENTA DE REGULACIÓN ÁRBOL DE LEVAS N. 2	
310267014	T10352 T10352/2	HERRAMIENTA DE REGULACIÓN ÁRBOL DE LEVAS N. 3	

PRÉCAUTIONS SPÉCIALES - LIRE ATTENTIVEMENT

- **Utiliser des gants anti-accident, des chaussures anti-accident, un casque de protection et des lunettes de protection**

- **Usage impropre:**

Le produit ne doit être utilisé que pour l'usage prévu dans la présente documentation. Tout autre usage doit être considéré comme impropre.

Le producteur décline toute responsabilité pour tout dommage découlant d'usages erronés ou irraisonnables de l'équipement.

L'usage impropre annule la garantie.

- **Prendre bien soin des outils:**

Toujours garder les outils bien propres.

Ranger les outils dans leur emballage d'origine.

- Débrancher le câble de la batterie du pôle négatif de terre (vérifier le code radio si disponible)
- Enlever les bougies afin de faciliter la rotation du moteur
- Ne pas utiliser de détergents liquides sur les courroies, les pignons et les tensionneurs
- Indiquer le sens de rotation de la courroie auxiliaire avant de l'enlever
- Faire tourner le moteur dans le sens des aiguilles d'une

montre (contraire seulement si spécifié)

- Ne jamais faire tourner l'arbre à cames, l'arbre moteur ou la pompe d'injection diesel lorsque la chaîne a déjà été enlevé (à moins que ce soit spécifié)
- Ne pas utiliser la chaîne de distribution pour bloquer le moteur quand les boulons de la poulie de l'arbre moteur se serrent ou se desserrent
- Ne pas faire tourner l'arbre moteur ou l'arbre à came lorsque la courroie/chaîne a déjà été enlevée
- Avant d'enlever la chaîne, indiquer sa direction
- Il est toujours conseillé de faire tourner lentement le moteur de façon manuelle et de vérifier le positionnement de l'arbre moteur et de l'arbre à cames.
- Les arbres à cames et moteur peuvent être tournée seulement lorsque le mécanisme d'actionnement de la chaîne/courroie est complètement installé.
- Ne pas faire tourner le moteur en actionnant l'arbre à cames ou d'autres engrenages
- Vérifier la position correcte de la pompe d'injection diesel après avoir remplacé la chaîne
- Observer tous les couples de serrage
- Toujours se reporter au manuel de maison constructrice ou au mode d'emploi fourni
- Une synchronisation du moteur imprécise ou raté entraîne l'endommagement des vannes

APPLICATION

A3 Cabrio	2.0 TFSI	CCZA	2009 - 2013
A3/A3 Sportback	2.0 TFSI	CCZA	2008 - 2013
A4	2.0 TFSI	CDNB	2008 - 2012
A4	2.0 TFSI	CDNB	2008 - 2013
A4	2.0 TFSI	CDNC	2008 - 2013
A4	2.0 TFSI FlexFuel	CFKA	2009 - 2015
A4 allroad	2.0 TFSI	CDNC	2009 - 2013
A4 quattro	2.0 TFSI	CDNC	2008 - 2013
A4 quattro	2.0 TFSI FlexFuel	CFKA	2009 - 2015
A5 Cabriolet	2.0 TFSI	CDNB	2008 - 2012
A5 Cabriolet	2.0 TFSI	CDNB	2008 - 2013
A5 Cabriolet	2.0 TFSI	CDNC	2008 - 2013
A5 Cabriolet	2.0 TFSI	CDNC	2008 - 2014
A5 Coupe	2.0 TFSI	CDNB	2008 - 2013
A5 Coupe	2.0 TFSI	CDNB	2008 - 2014
A5 Coupe	2.0 TFSI	CDNC	2008 - 2013
A5 Coupe	2.0 TFSI	CDNC	2008 - 2014
A5 Sportback	2.0 TFSI	CDNB	2009 - 2013
A5 Sportback	2.0 TFSI	CDNB	2009 - 2014
A5 Sportback	2.0 TFSI	CDNC	2009 - 2013
A5 Sportback	2.0 TFSI	CDNC	2009 - 2014
A6	2.0 TFSI	CDNB	2012 - 2014
A6	2.0 TFSI	CDNB	2012 - 2015
Q3	2.0 TFSI	CCZC	2011 - 2015
Q3	2.0 TFSI	CCZC	2012 - 2015
Q3	2.0 TFSI	CPSA	2011 - 2015
Q3	2.0 TFSI	CPSA	2012 - 2015
Q5	2.0 TFSI	CDNB	2009 - 2012
Q5	2.0 TFSI	CDNC	2008 - 2012
Q5	2.0 TFSI	CDNC	2008 - 2013
TT	2.0 TFSI	CCZA	2008 - 2010
TT	2.0 TFSI	CESA	2010 - 2014
TT	2.0 TFSI	CETA	2010 - 2014

AUDI

APPLICATION

Alhambra	2.0 TSI	CCZA	2010 - 2015
ALTEA/ALTEA XL	2.0 TSI Freetrack	CCZB	2009 - 2015
LEON	2.0 TFSI FR (Cupra)	CCZB	2009 - 2013
TOLEDO	2.0 TFSI	CCZB	2009 - 2009
OCTAVIA II	2.0 vRS	CCZA	2008 - 2013
SUPERB II	2.0 TSI	CCZA	2009 - 2015

SEAT

APPLICATION

CC	2.0 TSI	CCZB	2012 - 2015
Eos	2.0 TSI	CCZA	2009 - 2013
Eos	2.0 TSI	CCZB	2009 - 2014
Eos	2.0 TSI	CCZA	2009 - 2014
Eos	2.0 TSI	CCZB	2009 - 2015
Golf Vi	2.0 GTI TSI	CCZB	2009 - 2013
Golf Vi Cabrio	2.0 GTI	CCZB	2012 - 2015
Golf Vi Estate	2.0 TSI	CCZA	2009 - 2013
Jetta	2.0 TSI	CCZA	2011 - 2014
Jetta	2.0 TSI	CCZA	2011 - 2015
Passat	2.0 TSI	CCZB	2011 - 2015
Passat	2.0 TSI	CCZA	2009 - 2011
Passat Alltrack	2.0 TSI	CCZB	2012 - 2015
Passat Cc	2.0 TSI	CCZA	2009 - 2012
Passat Cc	2.0 TSI	CCZB	2010 - 2012
Scirocco	2.0 TSI	CCZB	2009 - 2014
Sharan	2.0 TSI	CCZA	2011 - 2015
Tiguan	2.0 TSI	CCZA	2009 - 2011
Tiguan	2.0 TSI	CCZB	2011 - 2015
Tiguan	2.0 TSI	CCZB	2011 - 2016
Tiguan	2.0 TSI	CCZC	2009 - 2011
Tiguan	2.0 TSI	CCZD	2011 - 2015
Tiguan	2.0 TSI	CCZD	2011 - 2016

VW

Code moteur	Code OEM				
	T40011	T10170; 1.860.895.000	T40265	T40267	T10352
CCZA
CDNB
CDNC
CFKA
CCZC
CPSA
CESA
CETA
CCZA
CCZB
CCZB
CCZB
CCZA
CCZB
CCZB
CCZB
CCZC
CCZD

Code moteur	Code OEM				
	T40271-1	T40271-2	T10352	T10352 T10352/1	T10352 T10352/2
CCZA
CDNB
CDNC
CFKA
CCZC
CPSA
CESA
CETA
CCZA
CCZB
CCZB
CCZB
CCZA
CCZB
CCZB
CCZB
CCZC
CCZD

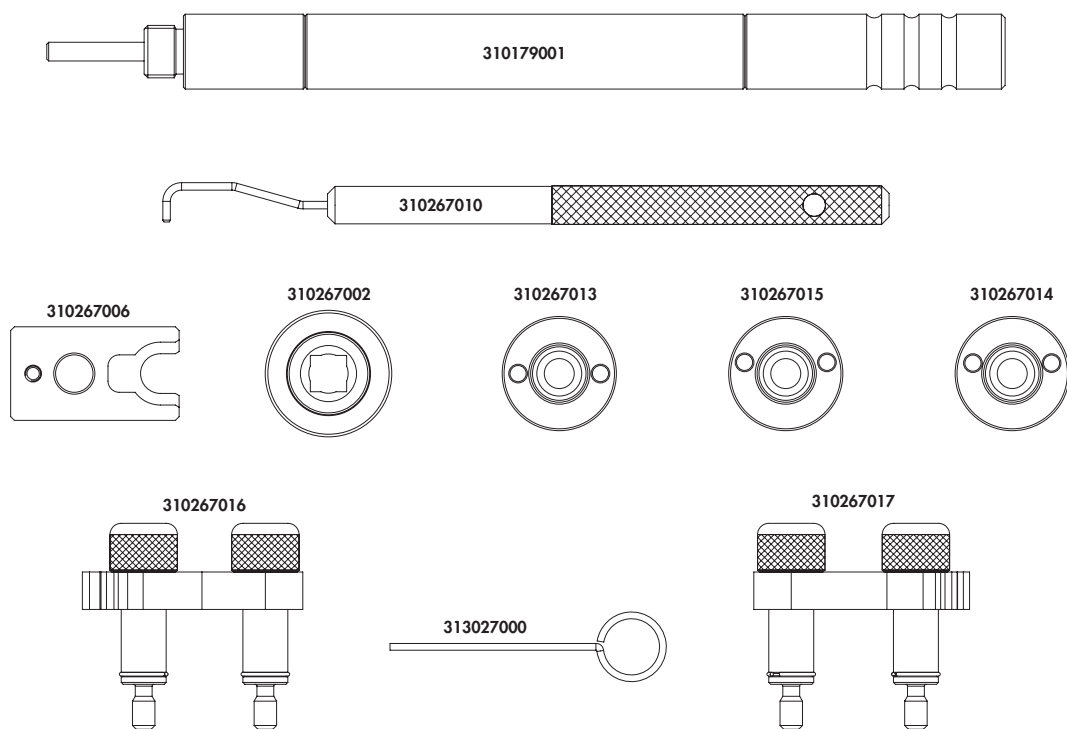

Components

313027000

T40011

TENSIONER LOCKING TOOL

**310179001**

T10170; 1.860.895.000

DIAL GAUGE SUPPORT

**310267010**

T40265

TENSIONER PULLEY LOCKING PIN

**310267006**

T40267

TIMING CHAIN TENSIONER

**310267002**

T10352

ADAPTER FOR CAMSHAFT ADJUSTMENT TOOL





**310267017**

T40271-1

CAMSHAFT CLAMP (INLET)



Components

310267016	T40271-2	CAMSHAFT CLAMP (EXHAUST)	
310267013	T10352	CAMSHAFT ADJUSTMENT TOOL N.1	
310267015	T10352 T10352/1	CAMSHAFT ADJUSTMENT TOOL N.2	
310267014	T10352 T10352/2	CAMSHAFT ADJUSTMENT TOOL N.3	

SAFETY PRECAUTIONS - PLEASE READ

- **Use protective work gloves, protective footwear, hard hat and safety goggles**

- **Misuse:**

This product should only be used as described in this documentation; any other use is considered improper. The manufacturer accepts no responsibility for any damage caused by the incorrect or unreasonable use of the equipment;

Moreover, misuse shall also void the warranty.

- **Take care of your tools:**

Be sure to store your tools in a clean state.

Place the tools inside their original package.

- Disconnect the battery earth leads (check radio code is available)
- Remove spark or glow plugs to make the engine turn easier
- Do not use cleaning fluids on belts, sprockets or rollers
- Always make a note of the route of the auxiliary drive belt before removal
- Turn the engine in the normal direction (clockwise unless stated otherwise)
- Do not turn the camshaft, crankshaft or diesel injection pump once the timing chain has been removed (unless specifically stated)
- Do not use the timing chain to lock the engine when slackening or tightening crankshaft pulley bolts
- Do not turn the crankshaft or camshaft when the timing belt/chain has been removed
- Mark the direction of the chain before removing
- It is always recommended to turn the engine slowly, by hand and to re-check the camshaft and crankshaft timing positions
- Crankshafts and Camshafts may only be turned with the chain drive mechanism fully installed
- Do not turn crankshaft via camshaft or other gears
- Check the diesel injection pump timing after replacing the chain
- Observe all tightening torques
- Always refer to the vehicle manufacturer's service manual or a suitable proprietary instruction book
- Incorrect or out of phase engine timing can result in damage to the valves
- It is always recommended to turn the engine slowly, by hand, and to re-check the camshaft and crankshaft timing positions

APPLICATION

A3 Cabrio	2.0 TFSI	CCZA	2009 - 2013
A3/A3 Sportback	2.0 TFSI	CCZA	2008 - 2013
A4	2.0 TFSI	CDNB	2008 - 2012
A4	2.0 TFSI	CDNB	2008 - 2013
A4	2.0 TFSI	CDNC	2008 - 2013
A4	2.0 TFSI FlexFuel	CFKA	2009 - 2015
A4 allroad	2.0 TFSI	CDNC	2009 - 2013
A4 quattro	2.0 TFSI	CDNC	2008 - 2013
A4 quattro	2.0 TFSI FlexFuel	CFKA	2009 - 2015
A5 Cabriolet	2.0 TFSI	CDNB	2008 - 2012
A5 Cabriolet	2.0 TFSI	CDNB	2008 - 2013
A5 Cabriolet	2.0 TFSI	CDNC	2008 - 2013
A5 Cabriolet	2.0 TFSI	CDNC	2008 - 2014
A5 Coupe	2.0 TFSI	CDNB	2008 - 2013
A5 Coupe	2.0 TFSI	CDNB	2008 - 2014
A5 Coupe	2.0 TFSI	CDNC	2008 - 2013
A5 Coupe	2.0 TFSI	CDNC	2008 - 2014
A5 Sportback	2.0 TFSI	CDNB	2009 - 2013
A5 Sportback	2.0 TFSI	CDNB	2009 - 2014
A5 Sportback	2.0 TFSI	CDNC	2009 - 2013
A5 Sportback	2.0 TFSI	CDNC	2009 - 2014
A6	2.0 TFSI	CDNB	2012 - 2014
A6	2.0 TFSI	CDNB	2012 - 2015
Q3	2.0 TFSI	CCZC	2011 - 2015
Q3	2.0 TFSI	CCZC	2012 - 2015
Q3	2.0 TFSI	CPSA	2011 - 2015
Q3	2.0 TFSI	CPSA	2012 - 2015
Q5	2.0 TFSI	CDNB	2009 - 2012
Q5	2.0 TFSI	CDNC	2008 - 2012
Q5	2.0 TFSI	CDNC	2008 - 2013
TT	2.0 TFSI	CCZA	2008 - 2010
TT	2.0 TFSI	CESA	2010 - 2014
TT	2.0 TFSI	CETA	2010 - 2014

AUDI

APPLICATION

Alhambra	2.0 TSI	CCZA	2010 - 2015
ALTEA/ALTEA XL	2.0 TSI Freetrack	CCZB	2009 - 2015
LEON	2.0 TFSI FR (Cupra)	CCZB	2009 - 2013
TOLEDO	2.0 TFSI	CCZB	2009 - 2009
OCTAVIA II	2.0 vRS	CCZA	2008 - 2013
SUPERB II	2.0 TSI	CCZA	2009 - 2015

SEAT

APPLICATION

VW	CC	2.0 TSI	CCZB	2012 - 2015
	Eos	2.0 TSI	CCZA	2009 - 2013
	Eos	2.0 TSI	CCZB	2009 - 2014
	Eos	2.0 TSI	CCZA	2009 - 2014
	Eos	2.0 TSI	CCZB	2009 - 2015
	Golf Vi	2.0 GTI TSI	CCZB	2009 - 2013
	Golf Vi Cabrio	2.0 GTI	CCZB	2012 - 2015
	Golf Vi Estate	2.0 TSI	CCZA	2009 - 2013
	Jetta	2.0 TSI	CCZA	2011 - 2014
	Jetta	2.0 TSI	CCZA	2011 - 2015
	Passat	2.0 TSI	CCZB	2011 - 2015
	Passat	2.0 TSI	CCZA	2009 - 2011
	Passat Alltrack	2.0 TSI	CCZB	2012 - 2015
	Passat Cc	2.0 TSI	CCZA	2009 - 2012
	Passat Cc	2.0 TSI	CCZB	2010 - 2012
	Scirocco	2.0 TSI	CCZB	2009 - 2014
	Sharan	2.0 TSI	CCZA	2011 - 2015
	Tiguan	2.0 TSI	CCZA	2009 - 2011
	Tiguan	2.0 TSI	CCZB	2011 - 2015
	Tiguan	2.0 TSI	CCZB	2011 - 2016
	Tiguan	2.0 TSI	CCZC	2009 - 2011
	Tiguan	2.0 TSI	CCZD	2011 - 2015
	Tiguan	2.0 TSI	CCZD	2011 - 2016

Engine code	OEM code				
	T40011	T10170; 1.860.895.000	T40265	T40267	T10352
CCZA
CDNB
CDNC
CFKA
CCZC
CPSA
CESA
CETA
CCZA
CCZB
CCZB
CCZB
CCZA
CCZB
CCZB
CCZB
CCZC
CCZD

Engine code	OEM code				
	T40271-1	T40271-2	T10352	T10352 T10352/1	T10352 T10352/2
CCZA
CDNB
CDNC
CFKA
CCZC
CPSA
CESA
CETA
CCZA
CCZB
CCZB
CCZB
CCZA
CCZB
CCZB
CCZB
CCZC
CCZD



MECCANOCAR ITALIA S.r.l.

Via Malta 2/1 - 16121 Genova - ITALY
Tel. + 39 0587 609433 | Fax + 39 0587 607145
mec@meccanocar.it | www.meccanocar.it